



SEPTEMBER 1998

RPO No: 6779 →

1 No XM - 5



DK 5 ENGINE

(2.5 l Turbo D)

- EVOLUTION : CAMSHAFT

"The technical information contained in this document is intended for the exclusive use of the trained personnel of the motor vehicle repair trade. In some instances, the information could concern the security and safety of the vehicle. The information is to be used by the professional vehicle repairers for whom it is intended and they alone would assume full responsibility to the exclusion of that of the manufacturer".
"The technical information appearing in this brochure is subject to updating as the characteristics of each model in the range evolve. Motor vehicle repairers are invited to contact the CITROËN network periodically for further information and to obtain any possible updates".

MAN 158931

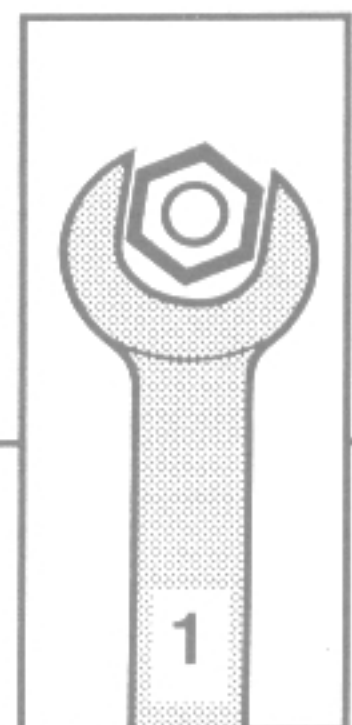

GB



AUTOMOBILES CITROËN
DIRECTION EXPORT EUROPE
DOCUMENTATION APRÈS VENTE

EVOLUTION : CAMSHAFT

1 – RECOMMENDED TOOLS

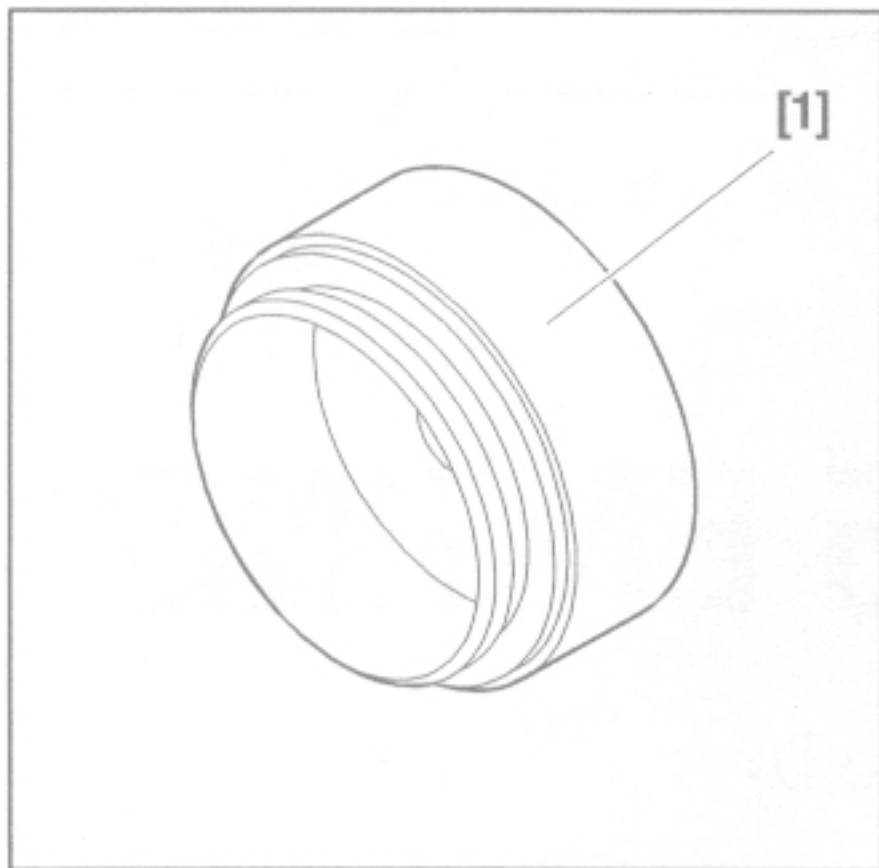

Fig : E5AP18PC

[1] fitting mandrel of the camshaft lipped seal
5711-T.M (clutch side) (tool box 5711-T).

2 – IDENTIFICATION

2.1 – Prior to RPO N° 6778

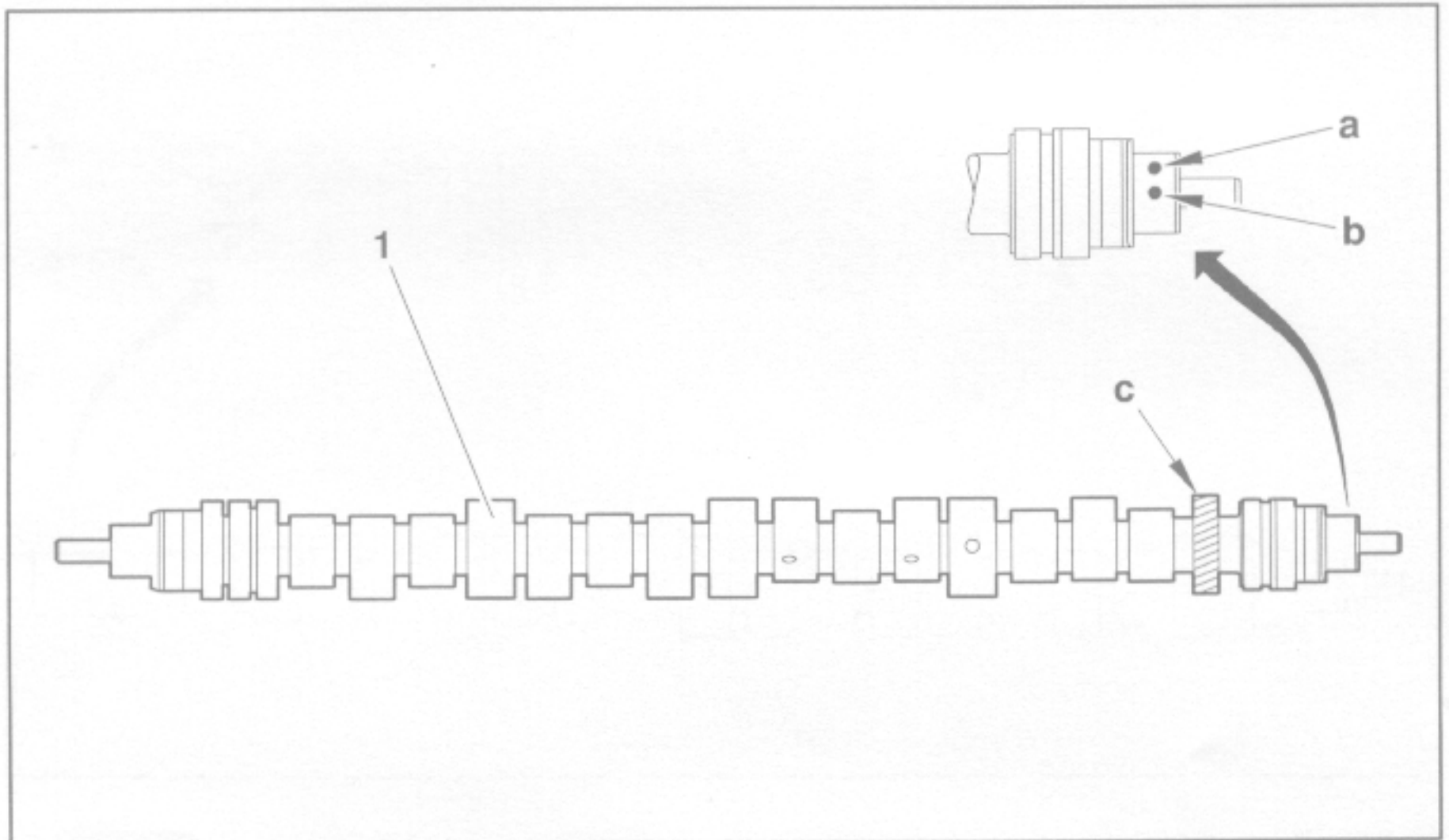

Fig : B1DP15LD

(1) camshaft.

NOTE : This part is no longer available from the Replacement Parts Division.

Referencing of the camshaft : holes at "a" and "b" (flywheel side).

The pinion "c" cannot be removed.

CYLINDER HEAD

2.2 – From RPO N° 6779

The camshafts are modified so that they can either drive a vacuum pump or not.

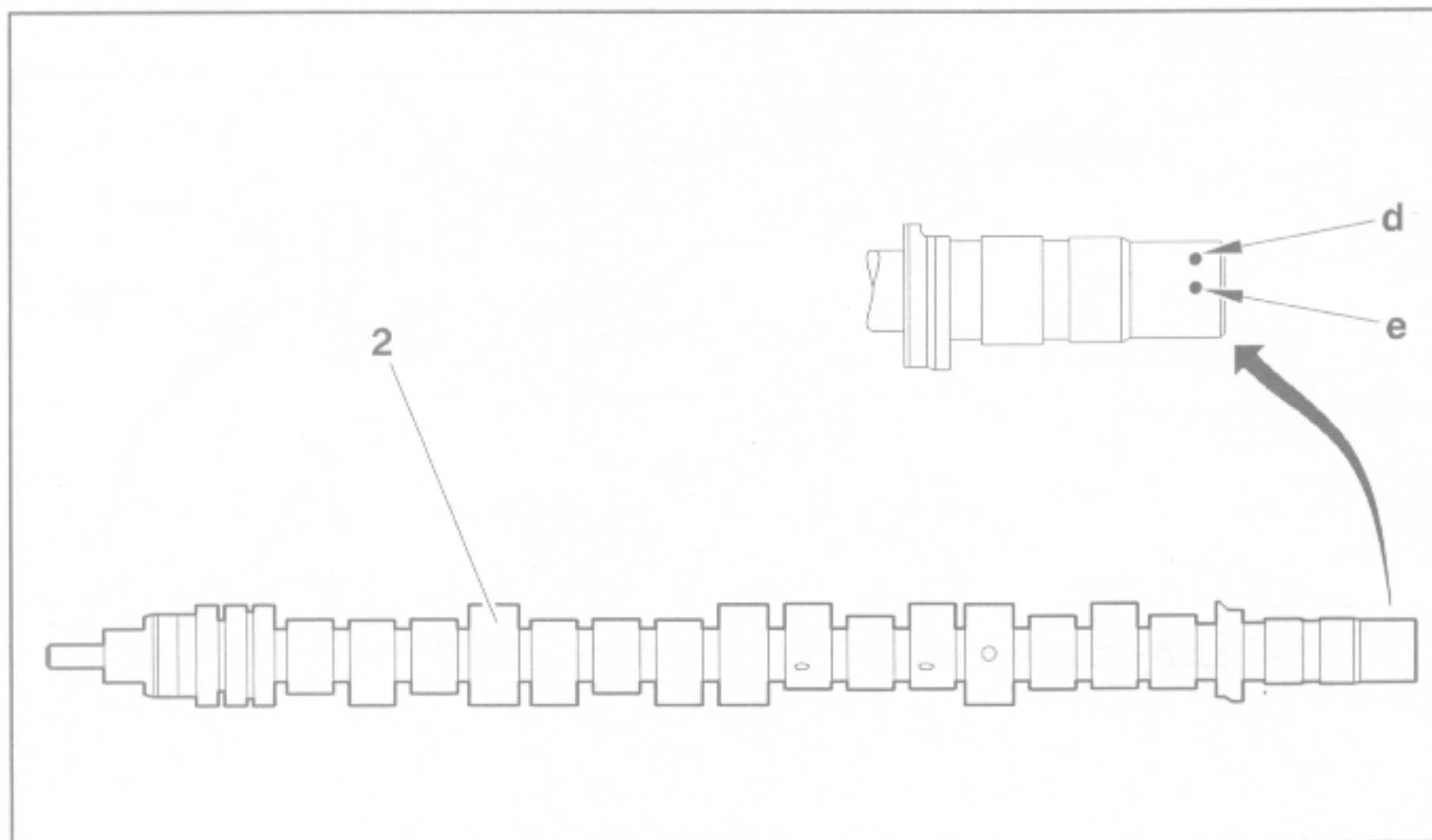

Fig : B1DP15MD

(2) camshaft.

Referencing of the camshaft : holes at "d" and "e" (flywheel side).

3 – NEW PARTS

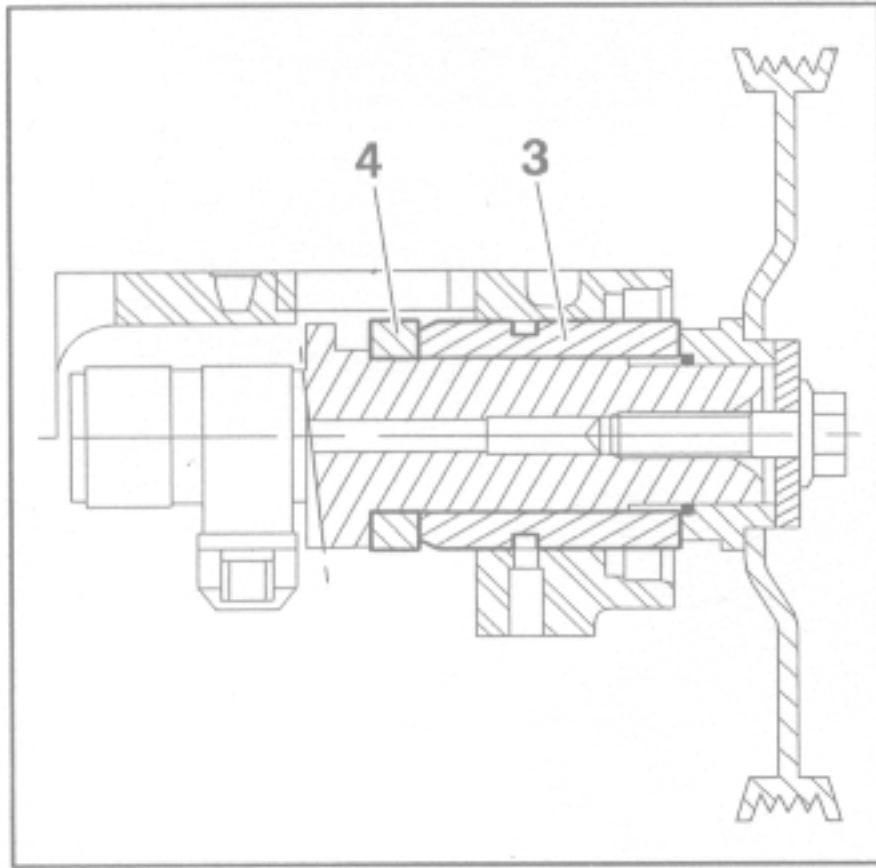

Fig : B1DP15NC

(3) intermediate bearing.

(4) spacer.

NOTE : The Replacement Parts Division sells the various parts in a kit.

4 – FITTING

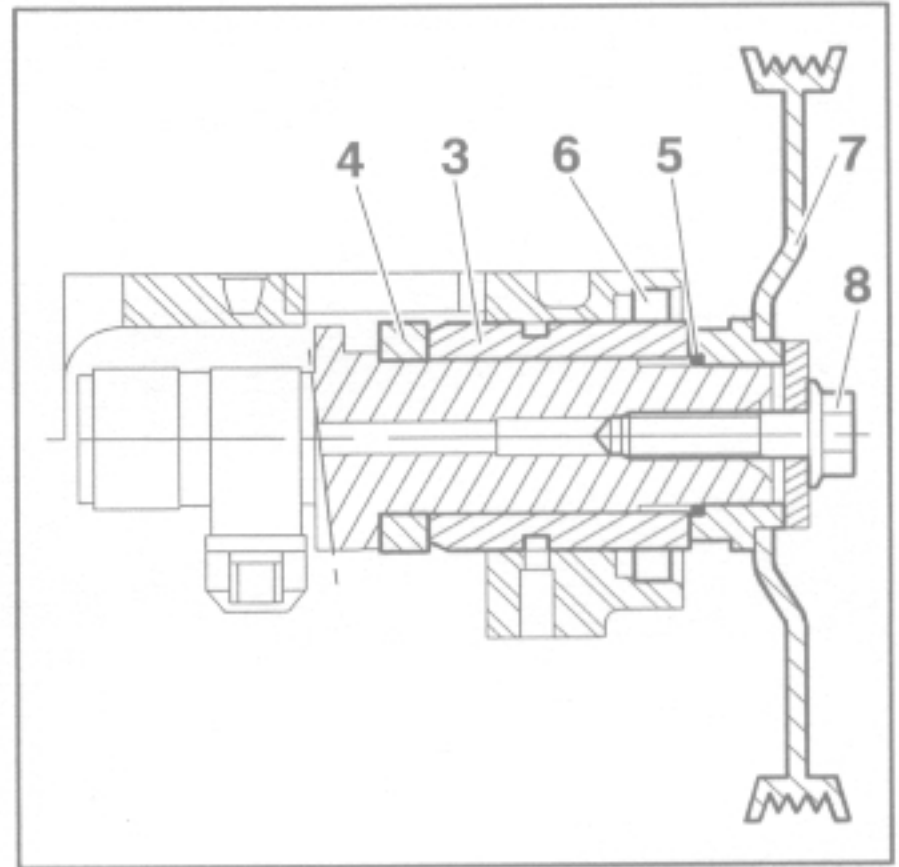

Fig : B1DP15PC

IMPERATIVE : The outer surface of the lip seal must be free from all traces of oil.

Fit :

- the spacer (4)
- the intermediate bearing (3)
- the O-ring (5)
- the lipped seal (6)
- the camshaft pulley (7)
- the screw (8)

Tighten the bolt (8) to 4.3 m.daN.