

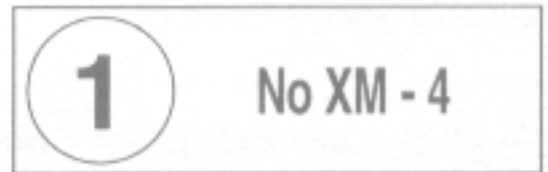

APRIL 1998

RPO No: 7116 →



# ENGINES ALL TYPES

(Except 2.5 TD)

## ● EVOLUTION : HEADER TANK

MAN 158931

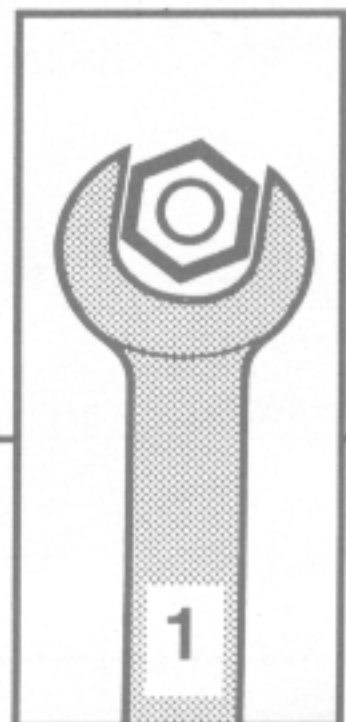

"The technical information contained in this document is intended for the exclusive use of the trained personnel of the motor vehicle repair trade. In some instances, the information could concern the security and safety of the vehicle. The information is to be used by the professional vehicle repairers for whom it is intended and they alone would assume full responsibility to the exclusion of that of the manufacturer".  
"The technical information appearing in this brochure is subject to updating as the characteristics of each model in the range evolve. Motor vehicle repairers are invited to contact the CITROËN network periodically for further information and to obtain any possible updates".



**AUTOMOBILES CITROËN**  
DIRECTION EXPORT EUROPE  
DOCUMENTATION APRÈS VENTE

## EVOLUTION : HEADER TANK

### 1 – VEHICLE APPLICATION

CITROEN XM (all engines except 2.5 TD).

### 2 – APPLICATION

Applicable from RPO number : 7116.

#### 2.1 – All models (except 2.0 Turbo CT)

Evolutions :

- 15 mm reduction in the length of the outlet union (3)
- height of the level sensor electrodes (4) 40 mm instead of 30 mm

**NOTE :** The hose connected to the outlet union (3) remains unchanged (charging the cooling circuit).

#### 2.2 – XM 2.0 Turbo CT (XU10 J2TE engine)

Evolutions :

- 15 mm reduction in the length of the outlet union (3)
- height of the level sensor electrodes (4) 40 mm instead of 30 mm

**NOTE :** Hose connected to the outlet union (3) extended by 15 mm (charging the cooling circuit).

### 3 – IDENTIFICATION

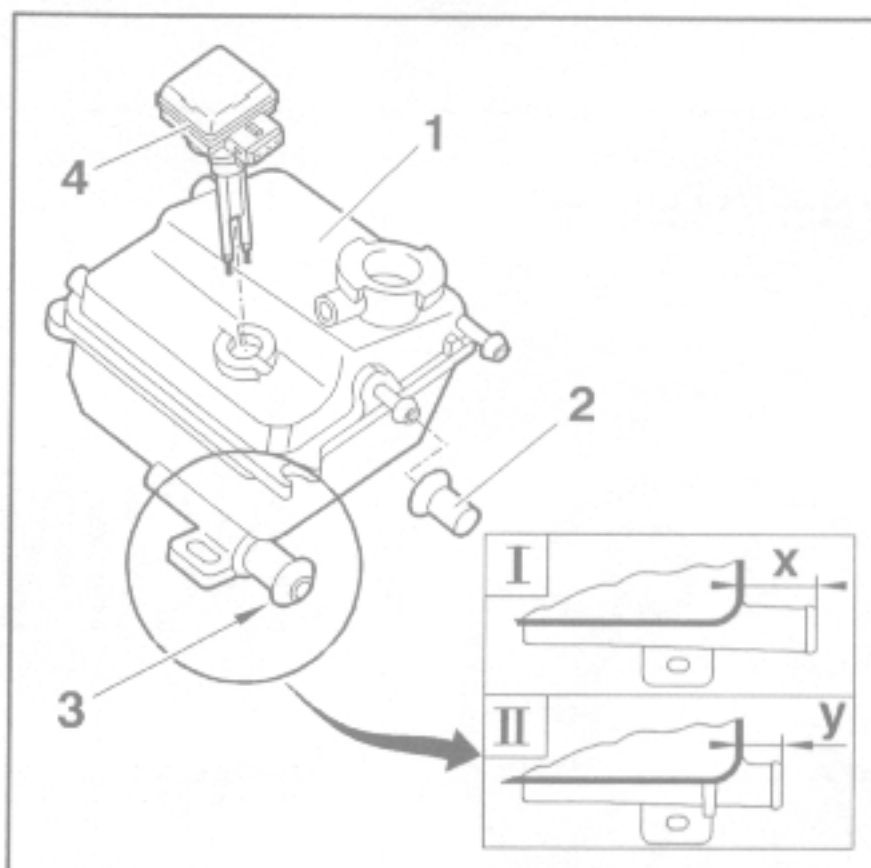

Fig : B1GP04XC

- (1) header tank.  
 (2) plug.  
 (3) outlet union.  
 (4) coolant fluid level sensor.

I – previous assembly : X = 26 mm.

II – new assembly : Y = 15 mm.

### 4 – REPLACEMENT PARTS

At present the Replacement Part Division supplies :

- header tank (new)
- coolant fluid level sensor (new and old)
- connecting hose (new and old)

When ordering a header tank, the following parts must be ordered :

- coolant fluid level sensor (new)
- a plug (2) with its mounting clip (according to model)

5 – INTERCHANGEABILITY

5.1 – All models (except 2.0 Turbo CT) : prior to RPO No. 6747

The new header tank is fitted instead of and in place of the old one without modifications on the following engines.

Engine	Number of valves	Supply	Engine type
2.0	8	Carburettor	XU102C
2.0	8	Monopoint injection	XU10M
2.0	8	Multipoint injection	XU10J2
2.0	16	Multipoint injection	XU10J4R
2.0 Turbo CT (refer to the Note)	8		XU10J2TE
V6	12	Multipoint injection	ZPJ
V6	24	Multipoint injection	ZPJ4
2.1 D	12	Naturally aspirated Diesel	XUD11A
2.1 Turbo D	12	Turbocharged Diesel	XUD11ATE / XUD11BTE

**WARNING** : Certain modifications have to be made from RPO N° 6748.

5.2 – XM 2.0 Turbo CT : from RPO number 6748 ; prior to RPO No. 7116

The new header tank can be fitted provided that a thermo-retractable sleeve is added to the cooling circuit charging hose.

5.2.1 – Part required

100 mm thermo-retractable sleeve – 30 mm diameter (sleeve not retracted).

RP reference : 9769 R3.

5.2.2 – Required tools

[1] hot air gun for "RAYCHEM" sleeve (tool box OUT 309 001T).

5.2.3 – Application

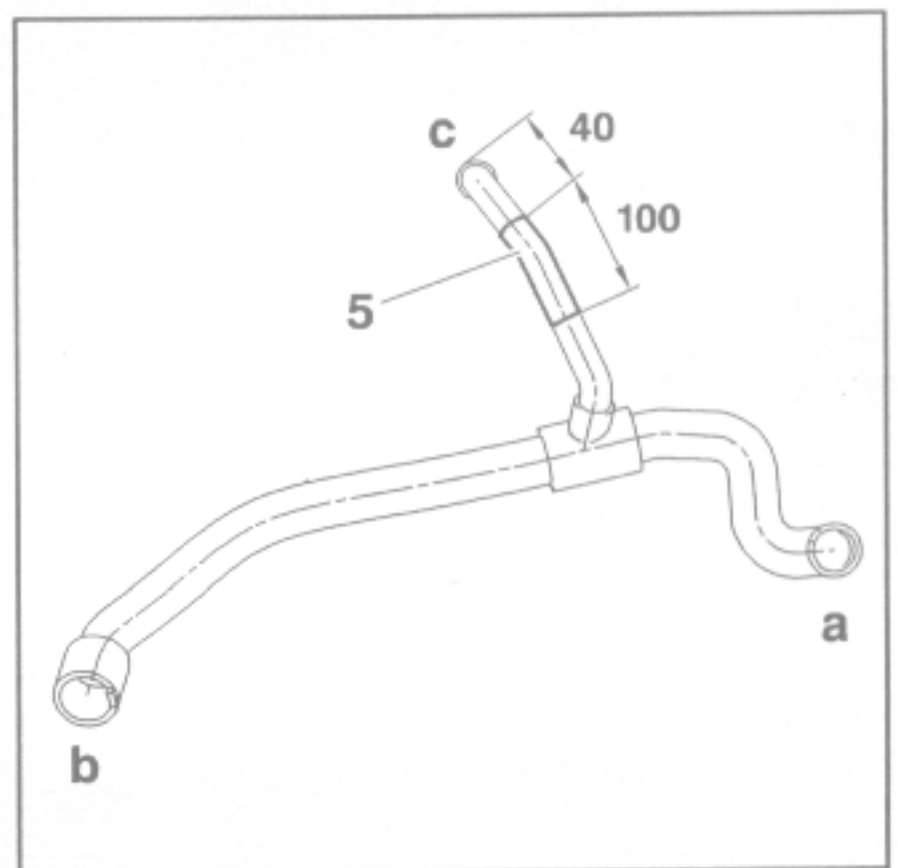

Fig : B1GP04YC

"a" to coolant inlet housing unit.

"b" to radiator.

"c" to header tank.

(5) thermo-retractable sleeve.

Put the sleeve (5) on the cooling circuit charging hose opposite the chassis member.

Heat the thermo-retractable sleeve with the tool [1] taking precautions regarding surrounding items.

# OBSERVATIONS

---